

## Acousti-Top™ for New Concrete Construction

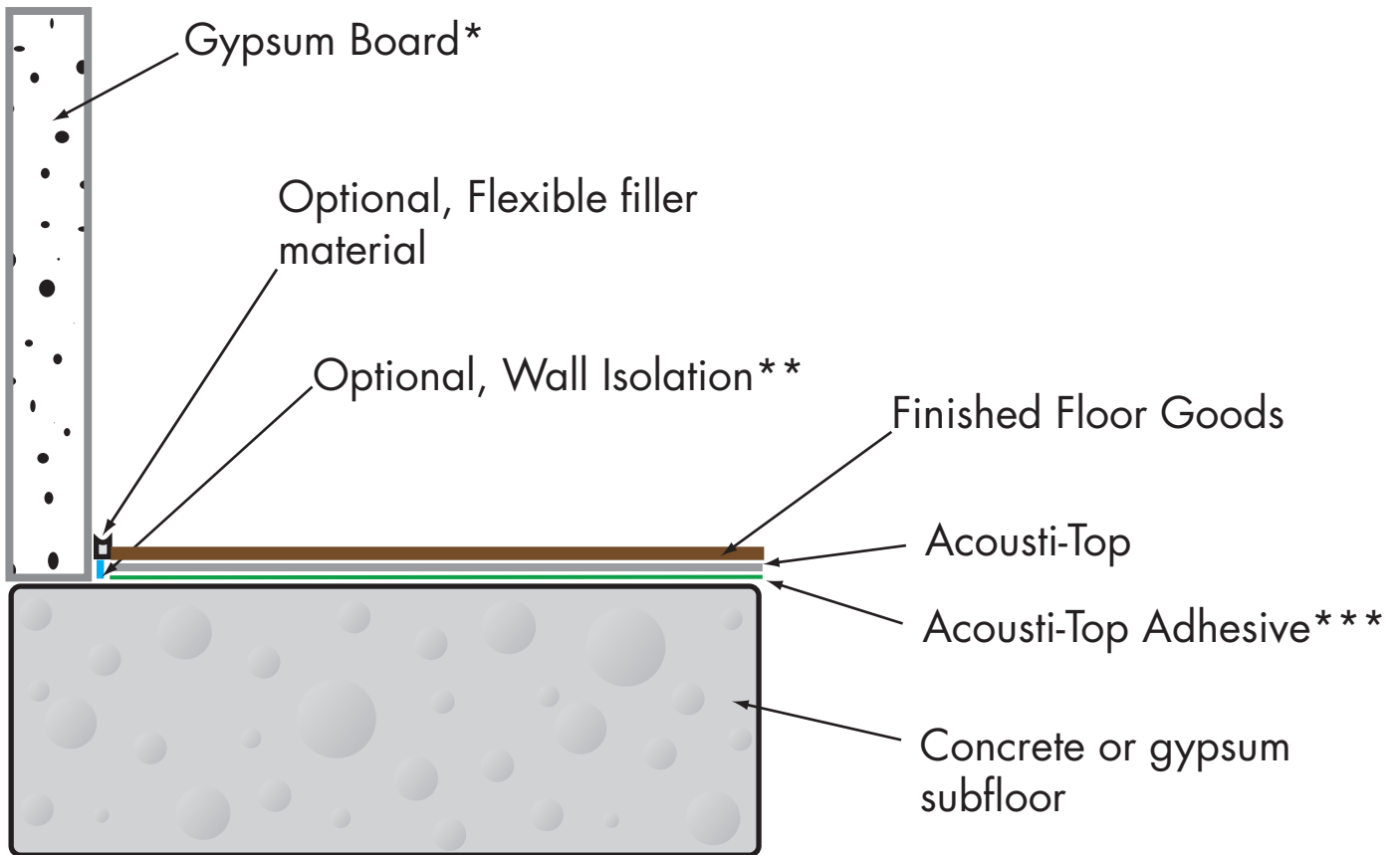

\* Gypsum Wall Board must be installed within 1/2 inch of subfloor

\*\*The installation of Acousti-Top does not eliminate the need for expansion or movement joints, including perimeter joints. An expansion of 1/4" must be maintained at all times. The use of Maxxon Perimeter Isolation Strips will assist in maintaining the expansion gap. Wall Isolation is installed around the perimeter of the entire room, and around any floor penetrations such as toilet collars, electrical, plumbing, etc.

\*\*\*Acousti-Top Adhesive used for double-glued applications. NOT required for floating floor applications. For floating applications, Acousti-Top seams should first be butt-jointed and then taped.