

**From Thin Topping to Deep Fill,
Floor Challenges Come in all Depths and Sizes.**



Office Complexes



Retail



Gymnasiums



Hospitals



Schools

With Level-Right®, Level-Right® PLUS, Level-Right® FS-10 and Level-Right® WearTop, You're Covered through

THICK and THIN.



LEVEL-RIGHT PRODUCTS
MAY HELP CONTRIBUTE
TOWARDS LEED POINTS

LEVEL-RIGHT®
Self-Leveling Floor Underlayment

LEVEL-RIGHT® FS-10
Fast Setting, 0-10mm

LEVEL-RIGHT® PLUS
Multi-Purpose Self-Leveling Floor Underlayment

LEVEL-RIGHT®
WearTop
Self-Leveling Floor Topping

Cover ANY Floor Challenge with LEVEL-RIGHT® LEVEL-RIGHT® FS-10 LEVEL-RIGHT® PLUS

Count on the Level-Right family to turn even the toughest floor challenges into smooth, level floors — just two to four hours after pouring!

NEED IT THICK? For 0–3" (0–76 mm) topping applications, Level-Right and Level-Right PLUS fill as needed — even large “duck ponds” and craters — with superior strength and drying speed.

NEED IT THIN? For thinner topping applications, Level-Right FS-10 provides 0–3/8" (0–10 mm) of concrete-capping power.

Level-Right, PLUS and FS-10 can level entire floors, new or old, and attain up to 7200 PSI (50 MPa). They work above, on or below grade, with no troweling required. Best of all, these cementitious products provide a temporary wear surface in as little as two to four hours after application.

Thick or thin, the Level-Right family can cover any floor challenge. And with authorized applicators worldwide, solutions are just a pour away.

- New construction or renovation
- Levels entire floors or transition areas, featheredge to deepfill
- Resurfaces old or damaged concrete floors
- Up to 7200 PSI (50 MPa), hydraulic cement
- Water resistant
- Caps cracked, lightweight concrete
- Above, on or below grade
- Fills “duck ponds” in concrete floors
- No troweling required
- Provides a temporary wear surface in as little as two to four hours after application
- Experienced, authorized applicators worldwide
- Exceeds standards set by leading floor goods manufacturers
- Can be used in any continuous pumping machine
- Supported by Maxxon® Corporation

Fast, Clean and Convenient.

Got a lot of floor to cover? Level-Right, Level-Right PLUS and Level-Right FS-10 are conveniently pumped in to save time, labor and cleanup.

Pour Today, Place Floor Goods Tomorrow.

Level-Right, Level-Right PLUS and Level-Right FS-10 help keep your job on the fast track with installation of finished floor goods just hours after the pour. Ceramic tile can be thin set within 2 to 4 hours. Other floor goods can be installed once Level-Right, Level-Right PLUS, or Level-Right FS-10 pass a moisture test.



As Level-Right/PLUS/FS-10 level, they fill in worn, cracked and damaged areas completely.



ON THE LEVEL — Level-Right/PLUS/FS-10 make old, rough, pitted concrete floors smooth and level.

Level-Right® Technical Data

Function	Interior underlayment for concrete or wood subfloors, not a wearing surface
Dry Density	Approx. 125 lbs./ft ³ (2003 kg/m ³)
Compressive Strengths (Modified ASTM C-109)	Typical: 3000 PSI (20.6 MPa) (3 days) 4500 PSI (31 MPa) (7 days) 5500 PSI (38 MPa) (28 days)
VOC Emissions	GREENGUARD Children & Schools Certified
Flexural Strength	1260 PSI (8.7 MPa) (28 days) (ASTM C-348)
Tensile Strength	720 PSI (5 MPa) (28 days) (ASTM C-190)
Surface Burning Characteristics	Flame Spread – 0, Fuel Contribution – 0– Smoke Development – 0 (ASTM E-84)
ICC-ES	Legacy Report ESR-2540
LEED Certification	May help contribute toward earning points, see www.MaxxonCorporation.com

Level-Right® PLUS Technical Data

Compressive Strengths Modified ASTM C 109	Typical: 3500 PSI (24 MPa) 1 day 4500 PSI (31 MPa) 7 days 5500-7000 PSI (38–48 MPa) 28 days
Dry Density	approx. 120–125 lbs/ft ³ (1922–2003 kg/m ³)
Tensile Strength ASTM C 190	810 PSI (6 MPa) (28 Days)
Flexural Strength ASTM C 348	1250 PSI (9 MPa)
LEED Certification	May help contribute toward earning points, see www.MaxxonCorporation.com

Level-Right® FS-10 Technical Data

Compressive Strengths Modified ASTM C 109	Typical: 1500 PSI (10.3 MPa) 1 day 5270 PSI (36.2 MPa) 7 days 5500-7200 PSI (38–50 MPa) 28 days
Freeze/Thaw Resistance ASTM C 666	90% +/- 3%
Dry Density	approx. 120–125 lbs/ft ³ (1922–2003 kg/m ³)
Tensile Strength ASTM C 190	1200 PSI (8.3 MPa) (28 Days)
Abrasion	ASTM Taber 250 Cycles, 1000 gram load on H 22, 4" wheels: wt. loss 0.30 gram
Shear Bond Strength with Concrete ASTM C 882-91	1060 PSI (7.3 MPa) 56 days
Shear Bond Strength with Level-Right FS-10 ASTM C 882-91	3160 PSI (21.7 MPa) 56 days
LEED Certification	May help contribute toward earning points, see www.MaxxonCorporation.com

LEVEL-RIGHT® WearTop®

Self-Leveling Floor Topping

Ideal for fast-track retrofits, Level-Right® WearTop® is the answer for old or damaged concrete floors that need a new, smooth and level wear surface. It installs with minimal prep and fast drying time. A self-leveling, portland cement-based topping, Level-Right WearTop is pumped in and quickly fills dips, voids and cracks to create a flat, hard wear surface. Get the look and strength of new construction, with less time and lower cost with the top solution for resurfacing concrete floors.

Level-Right WearTop Advantages

Saves Time – Fast installation and drying time allows work to continue sooner and reduces downtime.

Saves Money – Lower cost and maintenance than traditional floor coverings.

Safe Materials – Portland cement-based solution has no harmful solvents, epoxies or vapors.

Self-Drying – Water is chemically bound without evaporation. Sealer can be applied in two hours to prevent damage and reduce downtime.

Durable – Resilient surface, better than most floor coverings.



Also available in white
Ideal for staining and integral coloring.

Level-Right WearTop provides a new, smooth wear surface – fast.

Choosing the Right Self-Leveling Underlayment/Overlayment

	Level-Right®	Level-Right® PLUS	Level-Right® FS-10	Level-Right® WearTop
Installation Depths	0–3" (76 mm)	0–1½" (38 mm)	0–¾" (9.5 mm)	0–1" (25 mm)
Compressive Strength	Up to 5500 psi (38 MPa)	Up to 7000 psi (48 MPa)	Up to 7200 psi (50 MPa)	Up to 6200 psi (43 MPa)
Installation Over Existing Floor Goods	No shotblasting required	Shotblasting required	Shotblasting required	Shotblasting required
Polymer Modified	No	Yes	Yes	Yes
UL Rated	Yes	—	—	—
ICC-ES Listed	Legacy Report ESR-2540	—	—	—
GREENGUARD Children & Schools™ Certified	Yes	—	—	—
Recycled Content	Yes	Yes	Yes	—

SAMPLE USGBC LEED CREDIT AREAS IMPACTED BY LEVEL-RIGHT, LEVEL-RIGHT PLUS AND LEVEL-RIGHT FS-10*

Project	Credit	Category	How Requirement is Fulfilled
Indoor Environmental Quality	IEQ 3.2 ¹	Air Quality Before Occupancy	GREENGUARD Certified (Testing MUST be performed before claiming credit)
	IEQ 4.3 ¹	Low Emitting Materials: Floor System	GREENGUARD Children & Schools SM Certified
Materials & Resources	MR 2.1-2.2	Construction Waste Management	Recyclable packaging and shipping materials
	MR 4	Recycled Content	Fly Ash (Level-Right), Slag (Level-Right PLUS and FS-10)
	MR 5	Local/Regional Materials	Level-Right manufactured in Blue Rapids, KS 66411; Level-Right PLUS and FS-10 in West Grove, PA 19390. Job Site Manufactured with Local Sand & Water
Innovation & Design	ID 1 ¹	Sound Control	Enhanced living environment

*Credits may vary depending on project type and Maxxon products used. Contact Maxxon Corporation for complete information.
¹Credits only available with Level-Right.

Level-Right® WearTop Technical Data

Compressive Strengths Modified ASTM C 109	Typical: 4000 PSI (27 MPa) 3 day 5000 PSI (34 MPa) 7 days 6200 PSI (43 MPa) 28 days
Dry Density	120 lbs/ft ³ (1920 kg/m ³)
Tensile Strength ASTM C348	720 PSI (5 MPa) (28 Days)
Flexural Strength ASTM C 190	1440 PSI (10 MPa) (28 Days)
LEED Certification	May help contribute toward earning points, see www.MaxxonCorporation.com

SAMPLE USGBC LEED CREDIT AREAS IMPACTED BY LEVEL-RIGHT WEARTOP FLOOR UNDERLAYMENT*

Project	Credit	Category	How Requirement is Fulfilled
Materials & Resources	MR 2.1-2.2	Construction Waste Management	Recyclable packaging and shipping materials
	MR 5	Local/Regional Materials	Manufactured in West Grove, PA 19390 Job Site Manufactured with Local Sand & Water

* Credits will vary depending on project type and Maxxon products used. Contact Maxxon Corporation for more details.

Level-Right® UL Design Numbers

G524	J931	L206	L507	L519	L534	L547	L573	L599
G560	J957	L208	L508	L520	L535	L549	L574	M500
G561	J958	L209	L509	L522	L536	L551	L575	M503
G563	J966	L210	L510	L523	L537	L552	L579	M504
G566	J991	L211	L511	L524	L538	L555	L581	M505
G571	J994	L212	L512	L525	L539	L556	L583	
G574	K906	L501	L513	L526	L540	L557	L585	
J917	L004	L502	L514	L527	L541	L558	L588	
J919	L005	L503	L515	L528	L542	L560	L589	
J920	L006	L504	L516	L529	L543	L562	L592	
J924	L201	L505	L517	L530	L545	L563	L593	
J927	L202	L506	L518	L533	L546	L564	L594	

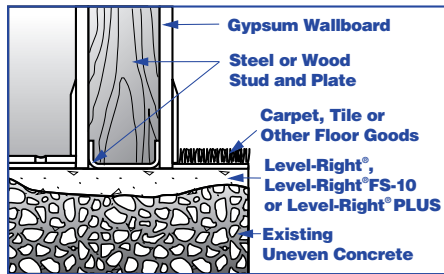
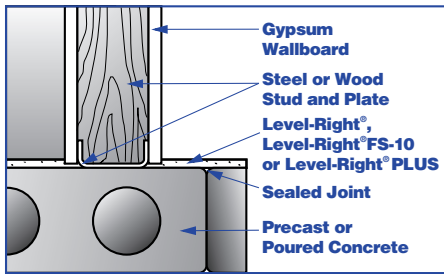

THE MOMENT THEY MEET THE FLOOR —
Level-Right/PLUS/FS-10 instantly level, filling in voids, dips and cracks, and quickly begin to set.

Installation

Level-Right, Level-Right PLUS and Level-Right FS-10 Preparation

Concrete subfloors must be fully cured, moisture free and have no efflorescence. The substrate surface shall be clean, dust and contaminant free. Cracks should be filled with a crack filler or an elastomeric compound. Plumbing or electrical penetrations should be packed with insulation and sealed.

WearTop Preparation

All subfloors must be structurally sound, solid, free of dirt, mud, dust, grease, curing and sealing compounds, and other contaminating factors. All subfloors must be dry and a minimum of 50 °F (10 °C). Mechanically clean the surface by shotblasting or scarifying. Shotblast to an ICRI Concrete Surface Profile 5 (CSP 5). On wooden floors a slipsheet must be used with galvanized metal lath. All cracks in the subfloor should be repaired to minimize telegraphing through the underlayment.

WearTop Installation Methods

Level-Right WearTop can be installed from a feather-edge to 1" (25 mm). Deeper areas can be poured in multiple lifts or prefilling with stone per manufacturer's recommendations.

The surface of the Level-Right WearTop must always be protected from oil, salt, water and surface wear by applying a Maxxon approved protection system such as a waterborne sealer. This is done 2-4 hours after installation of Level-Right WearTop.

For epoxy or seamless flooring installations over Level-Right WearTop, the manufacturer and installer of the flooring will be responsible for compatibility, bond test patches, installation recommendations and warranty. Because Maxxon Corporation does not perform the actual Level-Right WearTop installation, they cannot be held responsible for the results of epoxy or seamless flooring over Level-Right WearTop.

Testing

For Level-Right, Level-Right PLUS or Level-Right FS-10, field testing must be performed in accordance with modified ASTM C 109. Before independent sampling, contact the Maxxon quality control department to ensure that proper procedures are followed.

Limitations

- (1) Do not pour Level-Right, Level Right PLUS, Level-Right FS-10 or Level-Right WearTop where the floor temperature is less than 50 °F (10 °C) or greater than 100 °F (37.7 °C).
- (2) Protect the poured mortar from wind and sun, and from freezing temperatures for the first 72 hours.
- (3) The concrete subfloor must be structurally sound and able to withstand live and dead loads with a deflection limitation of L/360.
- (4) Level-Right, Level-Right PLUS, Level-Right FS-10 and Level-Right WearTop are non-structural underlayments, for interior use only, and not intended for use as wear-surfaces.
- (5) Level-Right, Level-Right PLUS, Level-Right FS-10 and Level-Right WearTop will not structurally bridge over expansion joints, saw cuts or structural cracks, which should be allowed to continue through the Level-Right, Level Right PLUS, Level-Right FS-10 or Level-Right WearTop. The architect or structural engineer must specify expansion joints and show their location in areas that will receive hard surface floor goods such as ceramic or marble tile, and hardwood flooring.
- (6) For Level-Right FS-10, maximum installation thickness without aggregate is 1/4" (8mm). For deeper pours use multiple lifts or add aggregate. For Level-Right PLUS, maximum installation thickness is 1 1/2" (38mm). For Level-Right, maximum

installation thickness is 3" (76 mm). For deeper fills with Level-Right WearTop, call Maxxon Corporation for the Application Bulletin.

(7) For applications other than those over structural concrete call Maxxon Corporation for the Application Bulletin.

(8) Maxxon underlayments are "breathable" and not a vapor barrier. The general contractor, architect, specifier, or building owner shall test slabs-on-ground or elevated slabs for MVER (ASTM F1869-09) or RH (ASTM F2170). If the MVER or RH of the concrete substrate exceeds the floor covering manufacturer's respective requirements for the finished flooring system, the concrete must be treated with Maxxon DPM before installation of a Maxxon underlayment.

(9) Level-Right WearTop is not a resurfacing topping for heavy-duty industrial floors or chemical environments requiring customized industrial toppings. Excessive service conditions, such as steel or hard-plastic wheeled traffic, dragging heavy metal equipment or loaded pallets with protruding nails over the floor can cause gouging and indentation.

For customized CSI specs for all Level-Right, Level-Right PLUS, Level-Right FS-10 and Level-Right WearTop applications, see www.MaxxonCorporation.com.



The Maxxon Green Mark
Maxxon products with this symbol are LEED-compliant and help to contribute valuable points toward LEED-certified projects.

LEVEL-RIGHT®

Self-Leveling Floor Underlayment

LEVEL-RIGHT® FS-10

Fast Setting, 0-10mm

LEVEL-RIGHT® PLUS

Multi-Purpose Self-Leveling Floor Underlayment

LEVEL-RIGHT® WearTop®

Self-Leveling Floor Topping

For more information:

1-800-356-7887

E-mail: info@level-right.com

www.MaxxonCorporation.com

Another superior product from

Maxxon® Corporation

920 Hamel Road • P.O. Box 253

Hamel, MN 55340 USA

763-478-9600

Fax: 763-478-2431



Level-Right®, Level-Right® FS-10, Level-Right® PLUS and Level-Right® WearTop are registered trademarks of Maxxon® Corporation, Hamel, MN. ©2004 Maxxon Corporation. Item #60039, printed in the USA TA 504-5920 5/10. The GREENGUARD INDOOR AIR QUALITY CERTIFIED® Mark is a registered certification mark used under license through the GREENGUARD Environmental Institute.